

AUGUST 12, 2024

IQ™ TOOLBOX 2.X - QUICK REFERENCE GUIDE

Contents

Introduction	3
What is iQ™ Toolbox 2.x?	3
Compatible Phone/Versions	3
Getting Started	4
Download and Login to iQ™ Toolbox.....	4
Quick Links	5
Account Activation Instructions.....	5
Bluetooth Pairing Setup	5
iQ Controller Installation and Operation Manual –	5
Automatic Slide Doors	5
iQ Controller Installation and Operation Manual –	5
Swing Doors and Fold Doors	5
Door Types.....	6
Controller Types.....	6
User Interface Overview	7
How to Connect to a Controller	7
Door Info Screen	8
Door Actions	9
Edit/View Parameters.....	10
Custom Profiles.....	11
Error History	13
Troubleshooting.....	14
Restart FIS.....	15
Firmware Update	16

Introduction

Welcome to iQ™ Toolbox! We're thrilled to have you on board.

What is iQ™ Toolbox 2.x?

iQ™ Toolbox 2.x is a mobile application specifically designed with the technician's perspective in mind. Its primary goal is to deliver a seamless and empowering experience to install and service technicians who work with STANLEY doors.

With its intuitive interface and robust features, iQ™ Toolbox 2.x ensures that technicians have all the tools they need at their fingertips to efficiently carry out their tasks. Whether it's installing doors or providing maintenance services, iQ™ Toolbox 2.x is tailored to enhance the productivity and effectiveness of technicians, making their work more streamlined and effective.

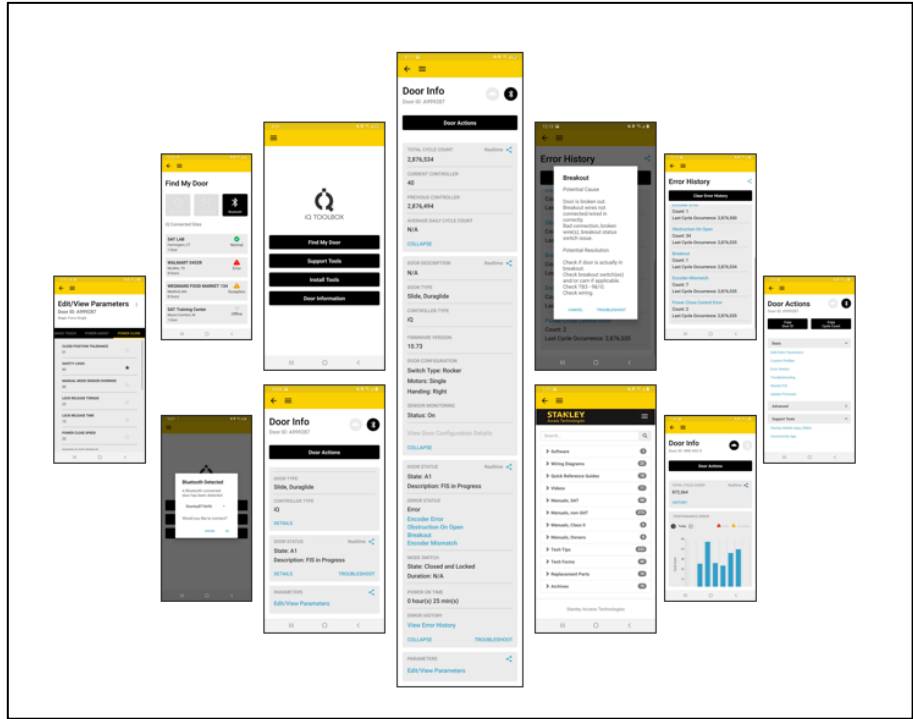

Compatible Phone/Versions

This is an Android-only mobile app designed for Android 11.0 and above.

For the **best experience**, we recommend using **Samsung** mobile devices. The app requires mobile data or wireless internet connectivity for a seamless user experience.



Getting Started

Download and Login to iQ™ Toolbox

To download the app, you have two options:

- Visit the Google Play Store, search for 'iQ Toolbox', and download the app.
- Alternatively, click on the following link to directly access the app on the Google Play Store:
 - <https://play.google.com/store/apps/details?id=com.STANLEYaccesstechnologies.iQtoolbox>
 - After installing the app, follow the instructions below to log in:

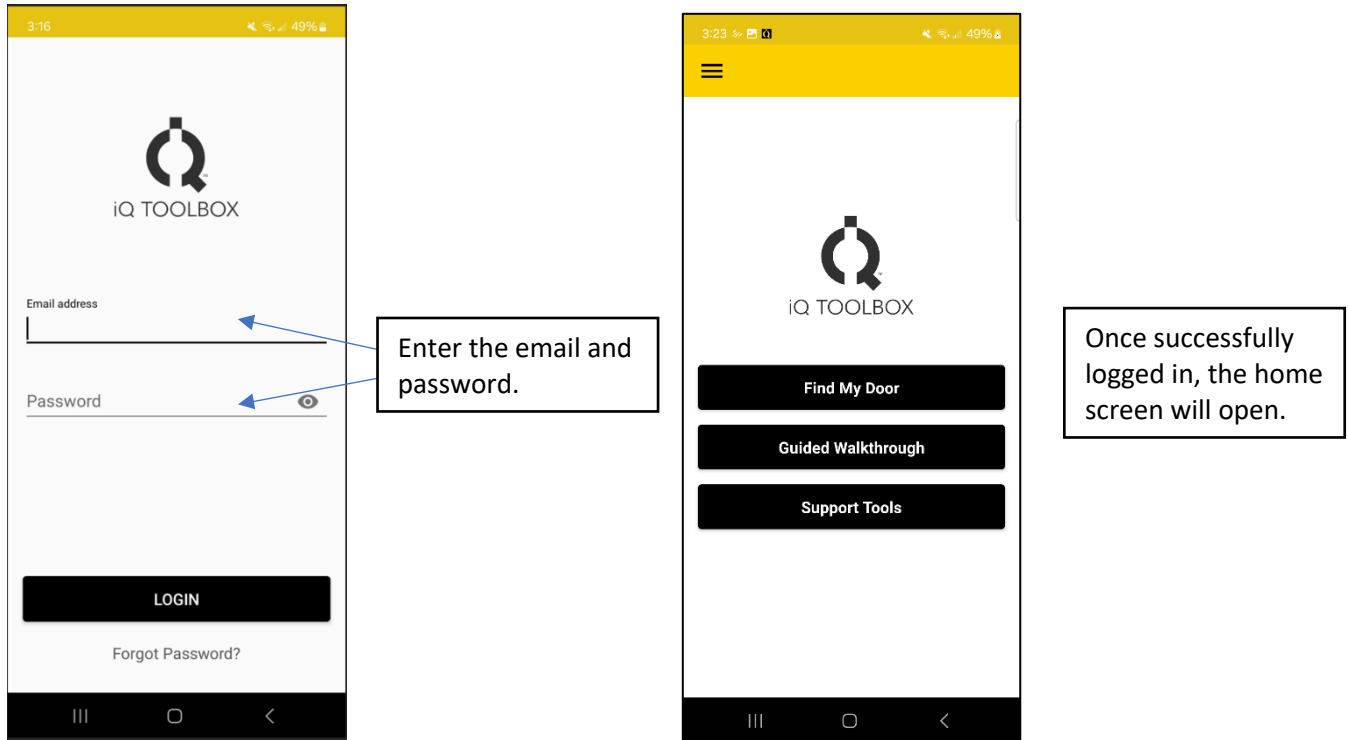

If you encounter any difficulties during the setup process, please don't hesitate to reach out to our support team for assistance.

Email: activate.iqtoolbox@allegion.com

Quick Links

Account Activation Instructions

Detailed account activation instructions can be found here:

<https://www.stanleyaccess.com/iq/activation>



Bluetooth Pairing Setup

Quick Reference Guide (QRG) for Bluetooth device can be found here:

<https://www.stanleyaccess.com/iq/bluetooth>



iQ Controller Installation and Operation Manual – Automatic Slide Doors

Automatic Slide Doors Installation and Operation Manual can be found here:

<https://www.stanleyaccess.com/iq/activation>



iQ Controller Installation and Operation Manual – Swing Doors and Fold Doors

Swing and Fold Doors Installation and Operation Manual can be found here:

<https://www.stanleyaccess.com/iq/activation>



Door Types

iQ Toolbox 2.x supports the following door types:

Slide/ICU	Swing	Bifold
		
<p>Supported Applications:</p> <ul style="list-style-type: none"> ▪ Duraglide ▪ Duraglide Drivethrough (iQ Only) ▪ Durastorm (iQ Only) ▪ DuraFit (iQ Only) ▪ Telescopic ▪ Procure (iQ Only) ▪ Cart Door (MC521 Only) 	<p>Supported Applications:</p> <ul style="list-style-type: none"> ▪ Magic Swing ▪ M-Force 	<p>Supported Applications:</p> <ul style="list-style-type: none"> ▪ Bifold Single ▪ Bifold Dual

Controller Types

iQ Toolbox 2x is fully compatible with iQ, MC521 Pro and MC521 controllers, supporting all STANLEY controller types from 2003 and above. One app for all your door configuration needs, providing a unified platform for seamless integration.

		
<p>iQ Year: 2019</p>	<p>MC521 Pro Year: 2012</p>	<p>MC521 Year: 2003</p>

User Interface Overview

How to Connect to a Controller

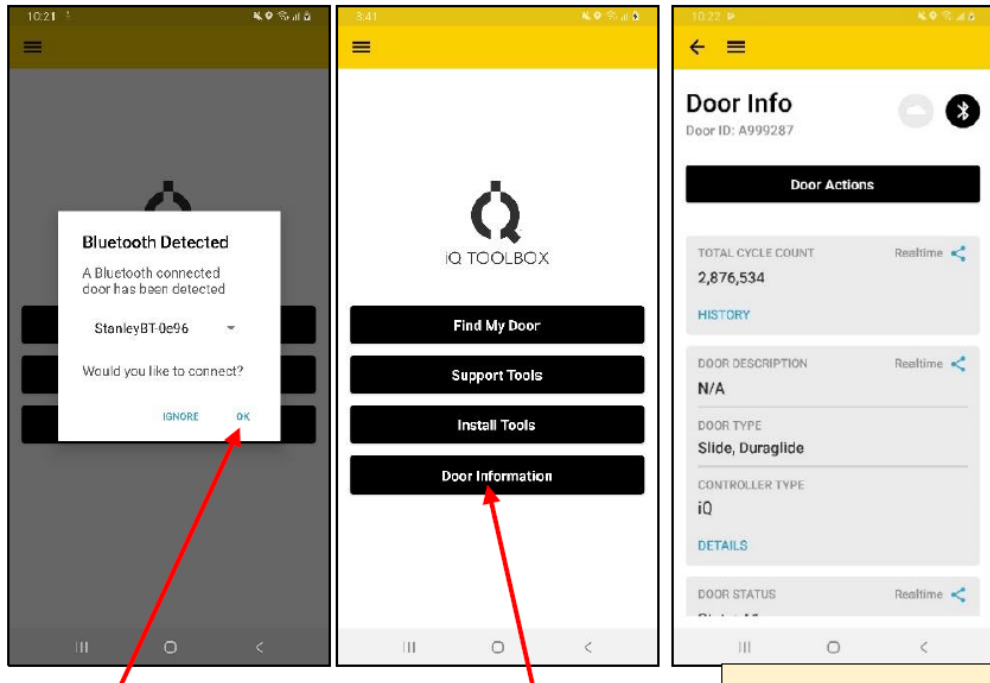

Step 1: Press 'OK' to connect to the controller.

Step 2: Press 'Door Information' to open the 'Door Info' screen.

Once the phone connects to the controller successfully, the Door Info screen will open.

Alternatively, the steps below can be followed:

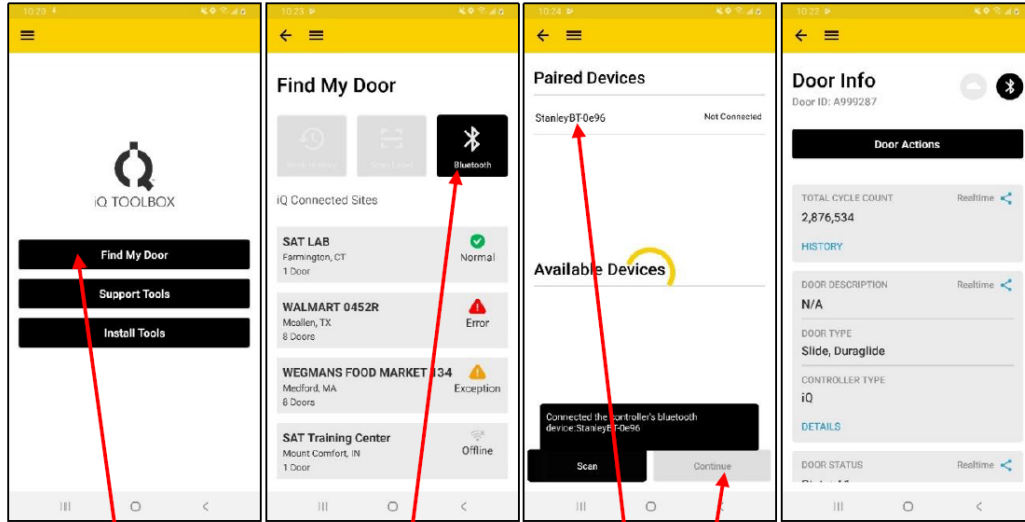

Step 1: Open 'Find My Door' from the home screen. **Step 2:** Press on 'Bluetooth' button to open the Bluetooth screen. **Step 3:** Press the desired Bluetooth module you'd like to connect to and press 'Continue'.

Once the phone connects to the controller successfully, the Door Info screen will open.

Door Info Screen

Each card in the Door Info screen can be expanded by pressing either the 'History' or 'Details' buttons. Once expanded, the 'Collapse' text can be pressed to return the cards back to its original length.

Critical information in the Door Info screen includes:

- Cycle Counts:** Number of times the door has cycled.
- Door type:** The type of door the controller is configured as.
- Door state:** The state the door is in
- Controller Type:** The type of control the technician is interfacing with.
- Mode Switch:** The mode at which the door is configured to be.

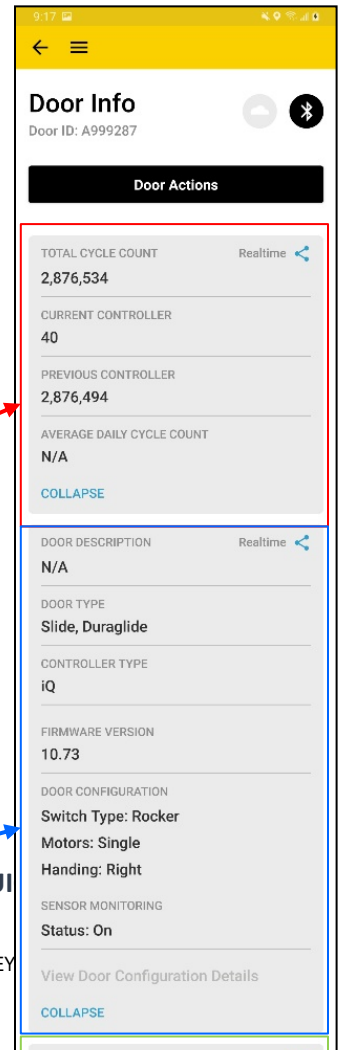
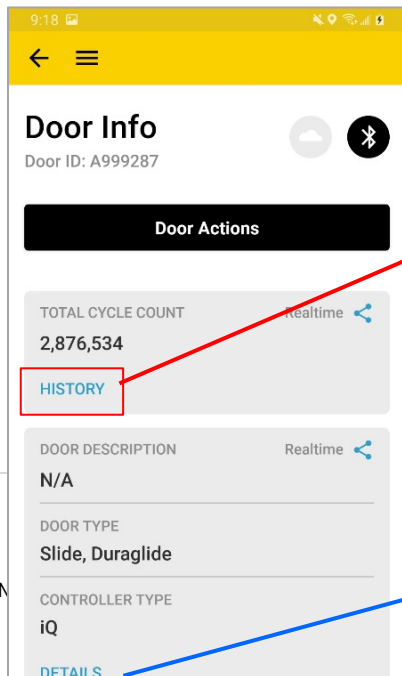

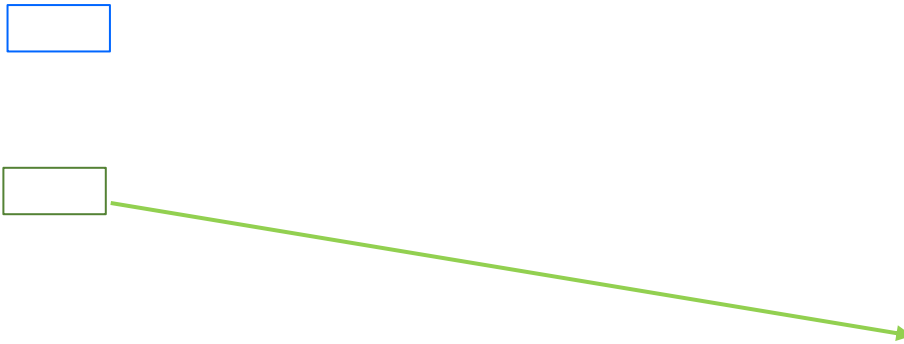

Door Actions

The Door Actions screen serves as a central hub for configuring and maintaining automatic doors, offering quick access to several key functionalities. From this screen, users can navigate to:

- Edit/View Parameters
- Custom Profiles
- Error History
- Troubleshooting
- Restart FIS
- Firmware Update

To access the **Door Actions** screen, follow these steps from the **Door Info** Screen:

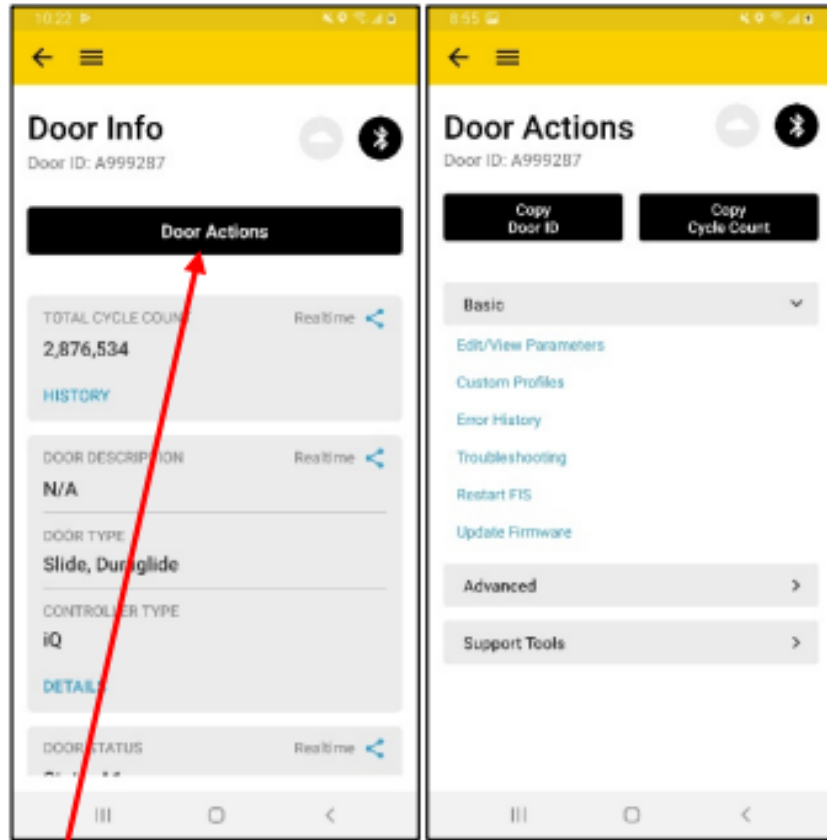

Press on the 'Door Actions' button to open.

The Door Actions screen will be opened. This screen can be used to navigate to several other features.

Edit/View Parameters

Edit/View Parameters screen is an essential interface designed for technicians to configure and fine-tune the settings of automatic doors. This screen provides access to a wide array of parameters that control various aspects of the door's operation.

To access the **Edit/View Parameters** screen, follow these steps from either of the two locations:

I. Access from Door Info screen

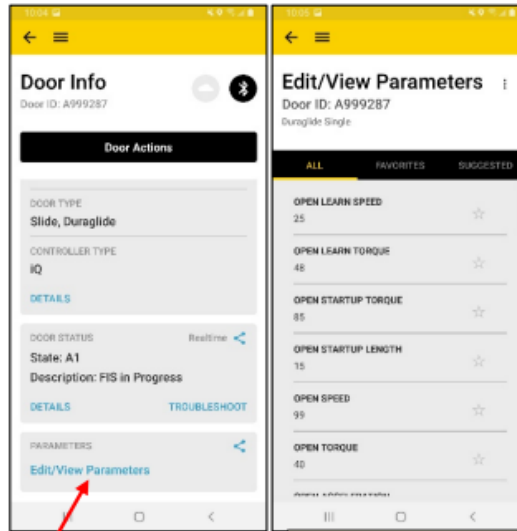

Scroll down and press 'Edit/View Parameters'.

The Edit/View Parameters screen will open. The first list will consist of all parameters applicable to the controller type/door type.

II. Access from Door Actions Screen

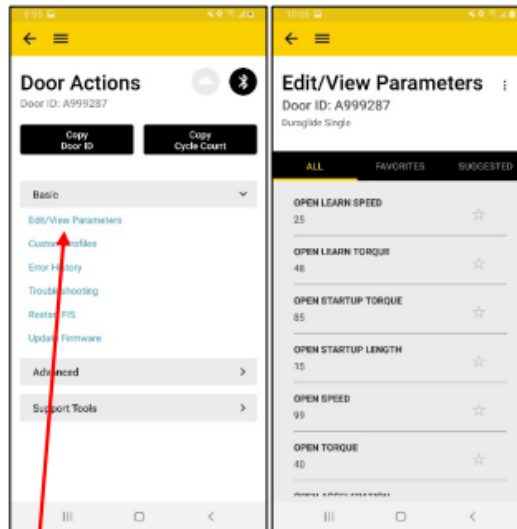

Under the Basic tab, press 'Edit/View Parameters'.

The Edit/View Parameters screen will open. The first list will consist of all parameters applicable to the controller type/door type.

Custom Profiles

Custom Profiles feature to apply predefined configurations by the user of iQ Toolbox 2x tailored to specific needs.

To access the **Custom Profiles** screen, follow these steps from the **Door Actions** Screen:

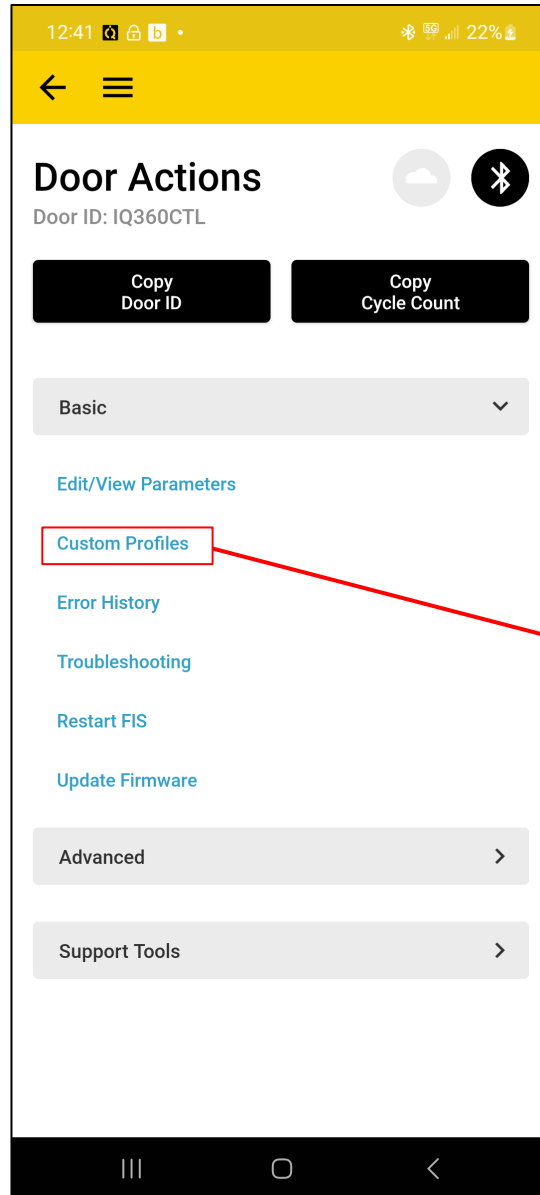

Press **'Custom Profiles'** and follow the steps.

Error History

Error History feature provides a log of past issues for diagnostic purposes.

To access the **Error History** screen, follow these steps from the **Door Actions** Screen:

I. Access from Door Info Screen

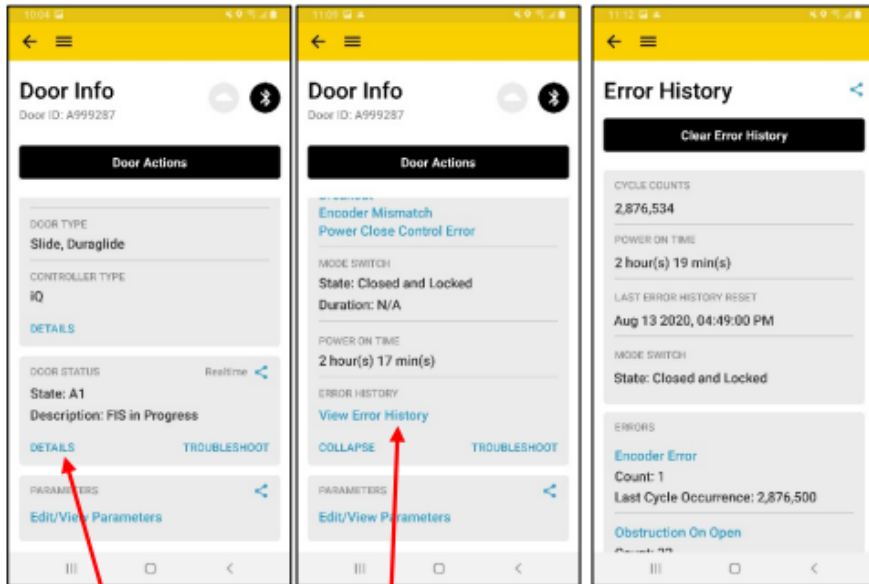

Step 1: Press 'Details' to expand the card.

Step 2: Press on 'View Error History'.

The **Error History** screen will open. This screen can be used to view/diagnose errors on the door.

II. Access from Door Actions Screen

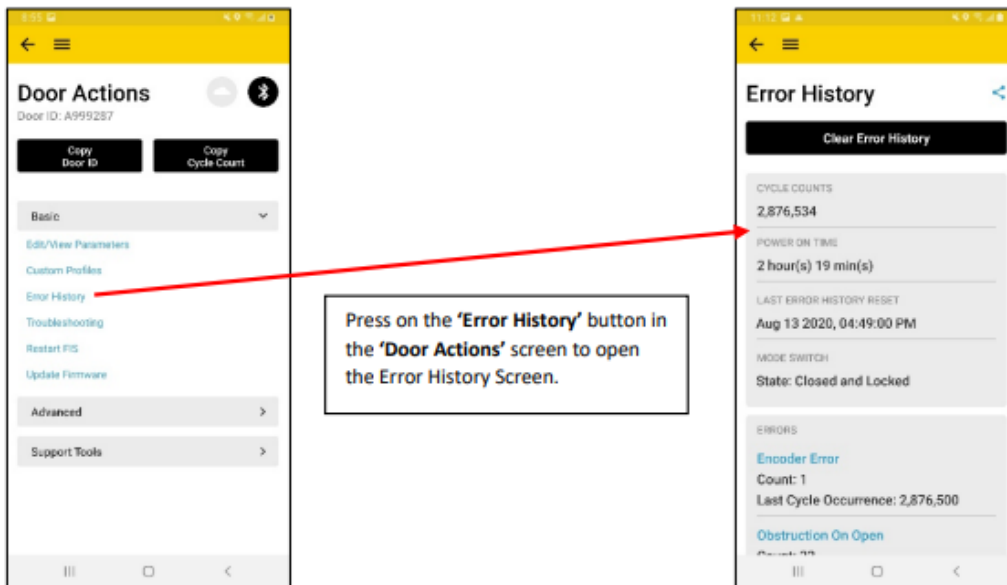

Press on the **'Error History'** button in the **'Door Actions'** screen to open the Error History Screen.

Troubleshooting

The troubleshooting screen offers tools and guidance for resolving current problems.

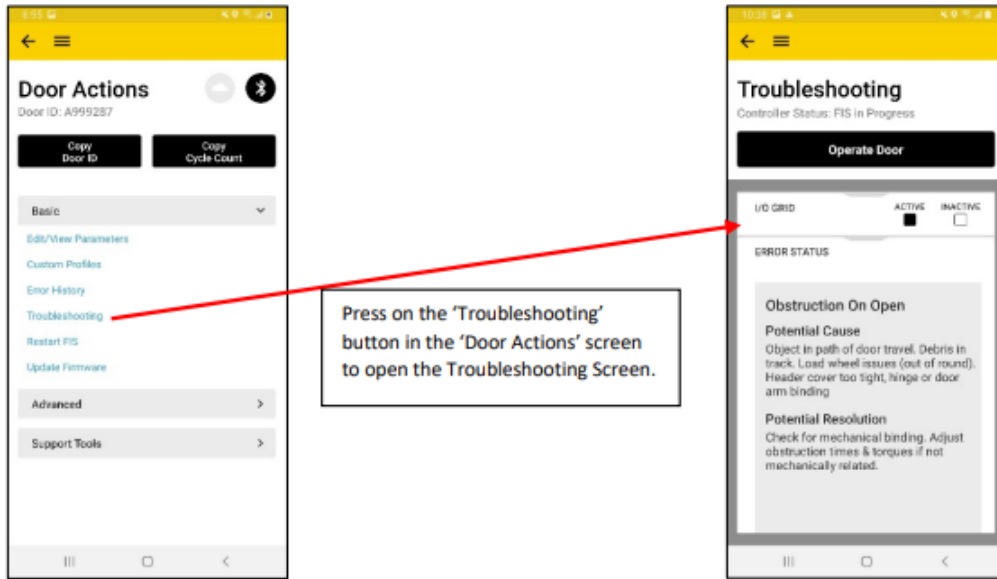

After opening the troubleshooting screen, to display the grid layout of all the inputs and outputs, the technician will have to press on the first stacked card called 'I/O Grid'.

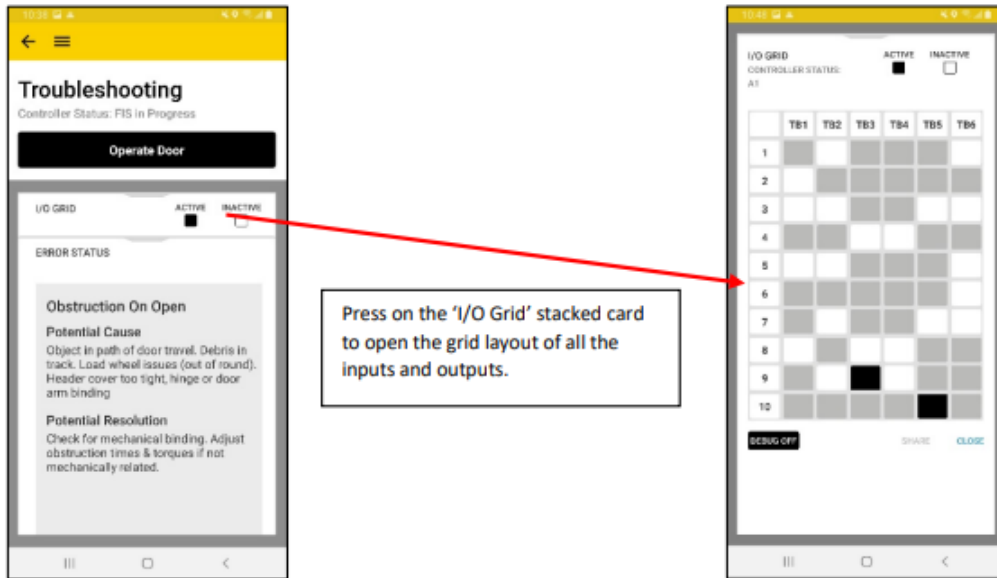

Restart FIS

FIS stands for First Install Sequence. It's the first step the technician performs after installing or swapping a controller.

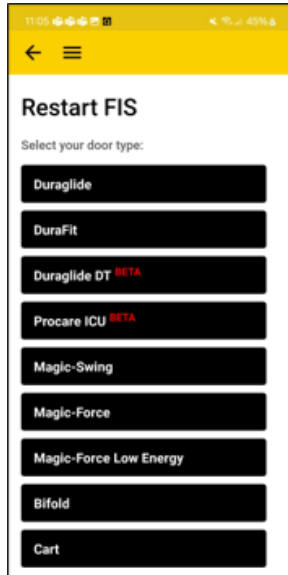

Step 1: Select the Door Type.

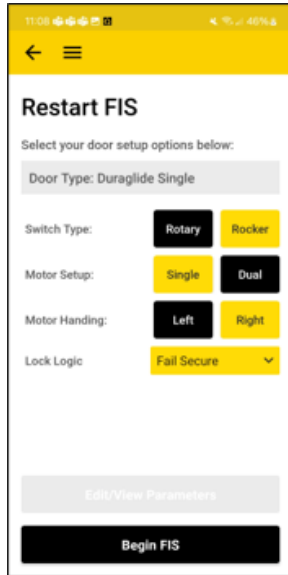

Step 2: Configure parameters and press 'Begin FIS'

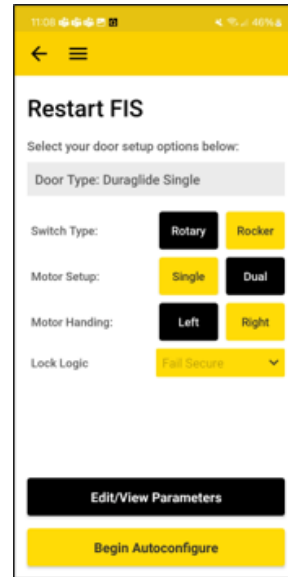

Step 3: Click 'Begin Autoconfigure'

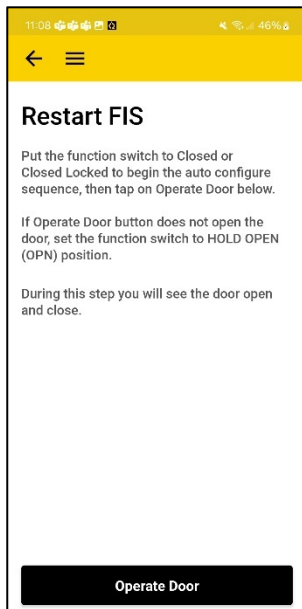

(NOTE: Door path must be free of objects and remain free until complete)
Step 4: Press Operate Door.

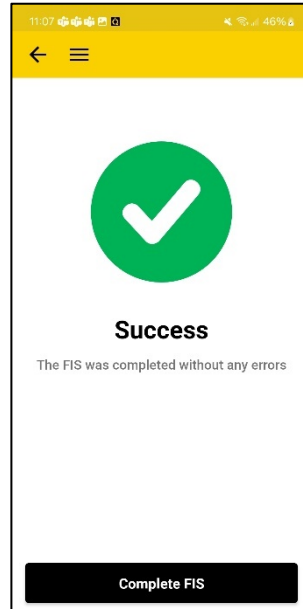

Complete the FIS by pressing 'Complete FIS'

Firmware Update

The **Firmware Update** feature ensures that the door's software is up-to-date and functioning optimally.

To update the firmware of a controller, follow these steps from the **Door Actions** Screen:

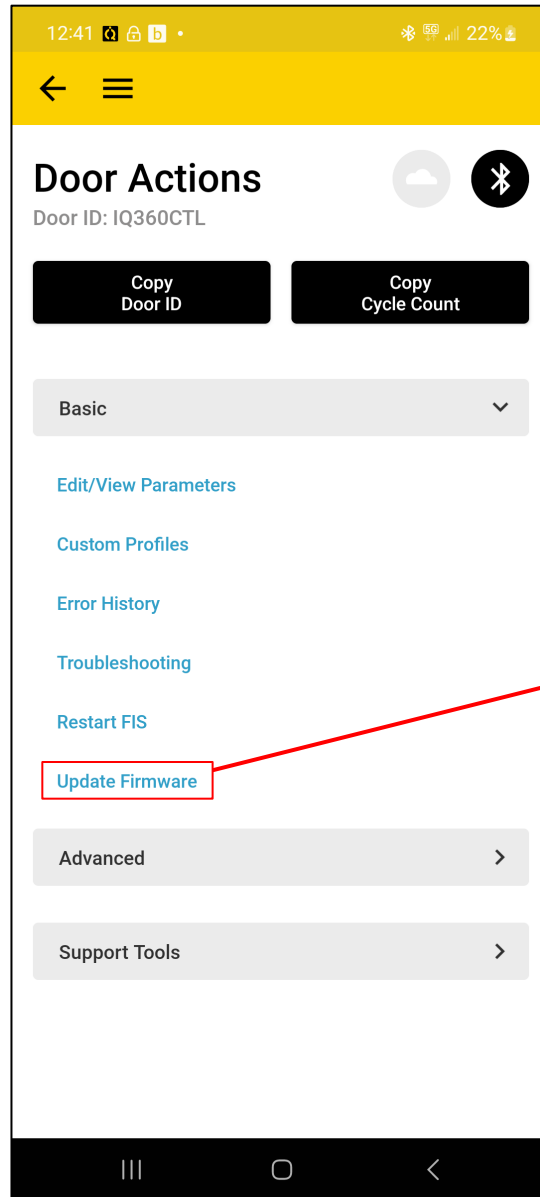

Press '**Update Firmware**' and follow the steps.